

АМУР-ИНСТРУМЕНТ-ЦЕНТР  
 профессионалами не рождаются, ими становятся

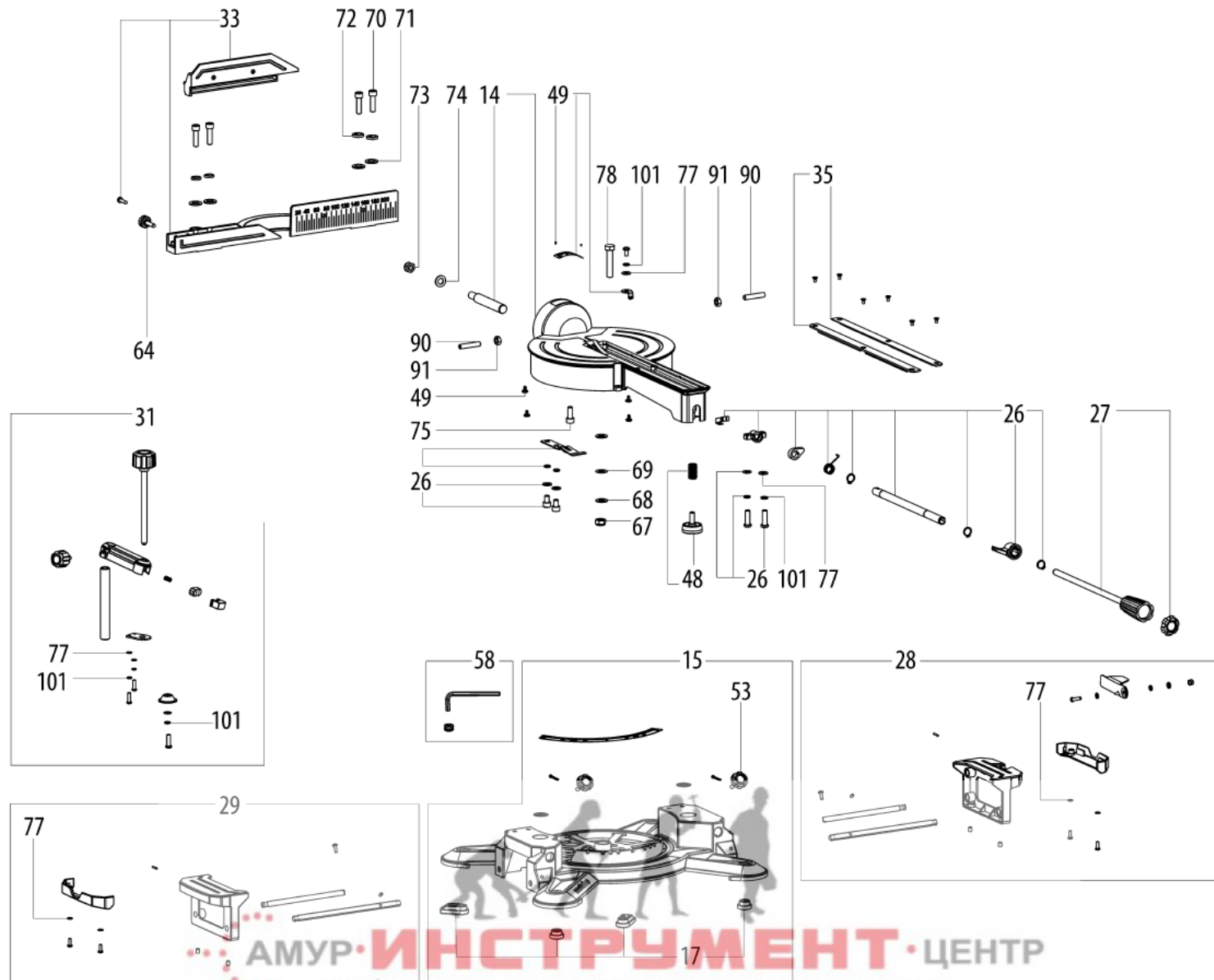

AMUR·ИНСТРУМЕНТ·ЦЕНТР  
профессионалами не рождаются, ими становятся

Позиция	Количество	Номер для заказа	Описание	PG
1	1	316092320	Carbon brush holder compl.	17
2	1	343435820	Motor cover	15
3	1	316060640	Flange compl.	22
4	1	316092330	Carbon brush set	17
5	1	343436090	LED-Lamp	20
6	1	343436110	Cover lighting	11
7	1	310011450	Stator	39
8	1	310011500	ARMATURE	41
9	1	316060710	Gear-box compl.	29
10	1	343254900	Condenser	11
11	1	316060720	upper handle with switch set	15
12	1	316092430	Switch compl.	21
13	1	343440900	Power supply	24
14	1	316055970	Turntable compl.	40
15	1	316055940	Table compl.	44
16	1	316056330	Safety guard compl.	26
17	1	315419090	Foot compl.	13
18	1	316060860	stress relieve compl.	23
19	1	316056250	Wheel guard compl.	39
20	1	316056730	Release lever compl.	14
21	1	316056930	SWIVEL LEVER compl.	25
22	1	343435740	Handle bottom part	25
23	1	316056090	Motor bracket compl.	30
24	1	316056120	Pivot compl.	46
25	1	316060950	Handle compl.	23
26	1	316092340	Detent compl.	22
27	1	316056800	Control grip compl.	19
28	1	315418530	Table side extension right	27
29	1	315418500	Table side extension left	27
30	1	316056290	Motor housing compl.	29
31	1	316056680	Workpiece holder compl.	25
32	1	316056760	Clamping lever compl.	16
33	1	316056010	Stop compl.	33
34	1	315418550	Rear pivot compl.	36
35	1	343436030	Table insert	15
36	1	343436070	Laser with holder	22
37	1	316056340	Dust etraction kit compl.	18
38	1	343435800	Cover dust collector	16
39	1	343436280	Extraction funnel	11
40	2	343436170	CABLE BRACKET	11
41	1	316056890	Spindle lock compl.	15

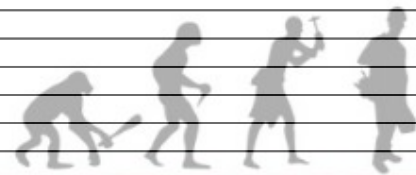

AMURINSTRUMENT-ЦЕНТР

профессионалами не рождаются, ими становятся

Позиция	Количество	Номер для заказа	Описание	PG
42	1	316061380	Transport lock compl.	12
43	1	316057470	Depth stop compl.	12
44	1	316061420	tipping axis compl.	26
45	1	343441110	Cover (cable channel)	11
46	1	344113030	Plug in buffer	11
47	1	339136700	cover pivot	11
48	1	316056830	Set screw compl.	11
49	1	316061450	Scale set compl.	15
50	1	316061500	Motor compl.	53
51	1	339147660	Sliding sheet	13
52	1	316061530	End stop cpl.	15
53	1	343436220	Star grip screw	11
54	1	316061540	Bearing compl.	14
55	1	341722210	Stop screw	11
57	1	344113050	Rubber bushing	11
58	1	316061550	Tool holder col.	11
61	1	338063100	Rating plate	11
62	1	343437020	Star grip screw	11
63	1	343084080	Electronic unit	29
64	1	343437050	Star grip screw	11
65	1	143111440	Ball bearing, 12x28x8	27
66	1	143115730	Ball bearing	14
67	1	141132030	Hex nut	11
68	1	141150050	Washer	11
69	1	141150390	Lock washer	11
70	1	141113890	Cap screw	12
71	1	141150130	Washer	11
72	1	141155240	Lock washer	12
73	1	141130890	Hexagonal lock nut	12
74	1	141156200	Washer	11
75	1	141113840	Cap screw	12
76	1	141110590	F lliester head screw	11
77	1	141150010	Washer	11
78	1	141113440	Hexagon head screw	12
79	1	141112180	Countersunk screw	11
80	1	141116780	F lliester head screw	11
81	1	141123710	F lliester head screw	11
82	1	141150020	Washer	11
83	1	141123840	Countersunk screw	11
84	1	141124510	HEX. SOCKET SET SCREW, FLAT PT M 6X8 VER	11
87	1	141150360	Lock washer	11

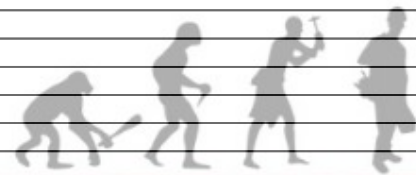

AMURINSTRUMENT-ЦЕНТР

профессионалами не рождаются, ими становятся

88	1	141110540	F Ilister head screw	11
90	1	141124460	HEX. SOCKET SET SCREW, FLAT PT	11
91	1	141131010	Hexagonal nut	11
92	1	141123410	Grub screw	11
93	1	141116480	Grub screw	11
94	1	141113590	Cap screw	12
95	1	141124470	CROSS REC'D PAN HEAD TAP.SCREW ST 4,2X9,	11
96	1	141111430	F Ilister head screw	12
97	1	141118730	Self-tap. fill. h. screw	11
98	1	141116800	Self-tap. fill. h. screw	11
99	1	141123940	Self-tap. fill. h. screw	11
100	1	141113220	F Ilister head screw	11
101	1	141150350	Lock washer	11
1001	1	338505980	Wiring diagram	



